

National Council of Churches in Australia  
9<sup>th</sup> National Forum



24-27 June 2016  
Mary MacKillop Place  
Mount and William Street  
North Sydney

### Mary MacKillop Place

Entrance via either 7-11 Mount Street or 80 William Street (NB security intercom at gate)

By Taxi – ask the driver to set you down at either entrance

### If you arrive at the Airport

- By train  
Airport Station, Platform 1  
Platform 1, T2 Airport, Inner West & South Line  
Stopping at Domestic-Mascot-Green Square - alight Central Station, change here.  
Go to Platform 16, T1 North Shore, Northern & Western Line  
Central-Town -Hall-Wynyard-Milsons Point – alight North Sydney  
Walk 235 m Left 125 m along Blue St, then right 110m along William St

### From Central Station

- By bus  
M20 to Gore Hill catch bus at Central Station, Chalmers St Stand H  
Alight – North Sydney Station, Blue St Stand B

### Please note

- Delegates with accommodation at MMP will need to check in at the reception desk at Anderledy Lodge which is directly accessible through the William St gate.
- The Forum registration desk will be located in the foyer of the Isobel Manton theatre which has access from Mount St and the inner courtyard near Anderledy Lodge.
- Parking on site is limited. Street parking is metered but there are a number of parking stations in the area.



Map of Venue

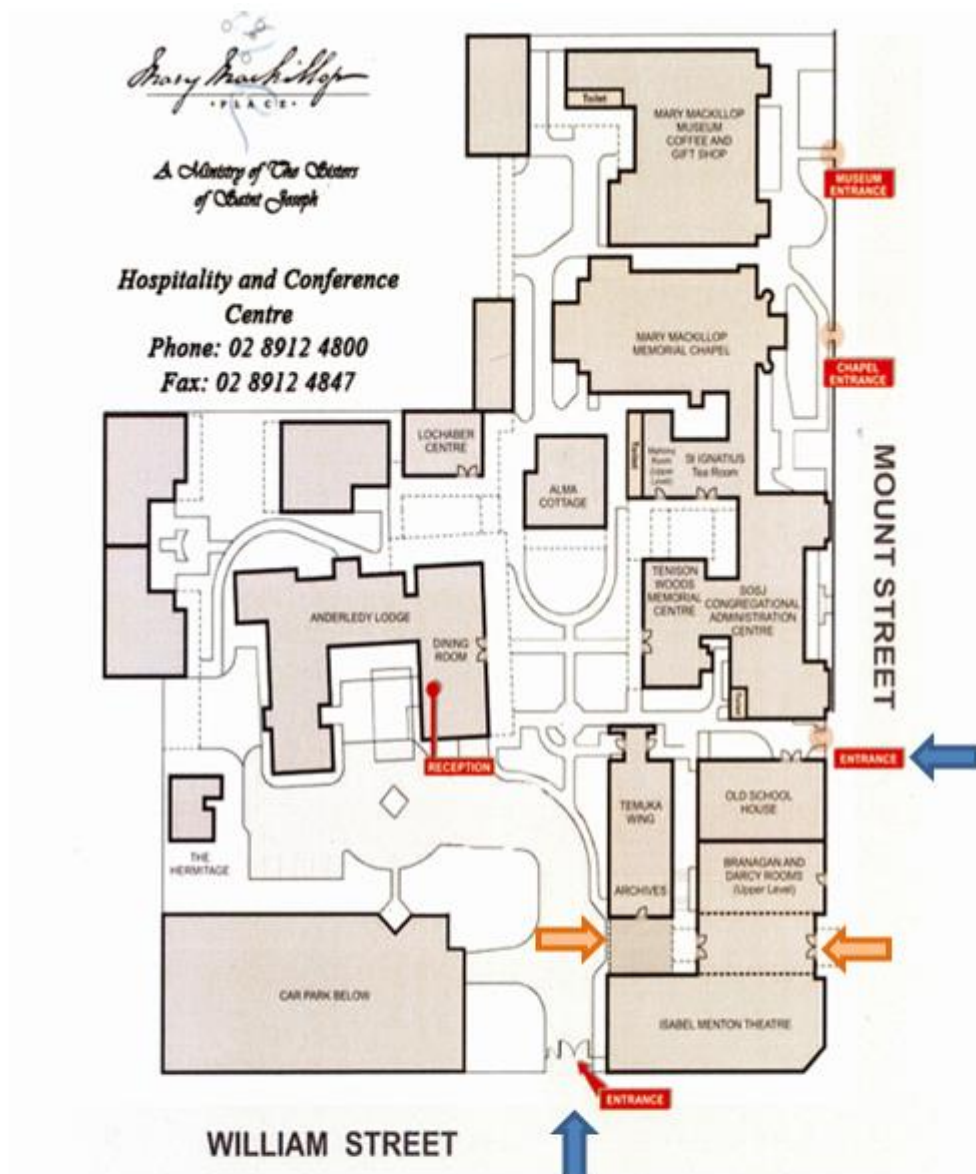

KEY

	Arrival check in for accommodation
	Entrance to MMP
	Entrance to Forum registration desk